



## PNSY ENCLOSURES WITH RETRACTABLE ROOFS - KITTERY, ME

### PROJECT INFO:

**OWNER:**

Portsmouth Naval Shipyard - U.S. Navy

**ENGINEER:**

Naval Facilities Engineering Command

**PROJECT VALUE:**

Confidential

**TECHNOLOGIES/MATERIALS:**

Special Steel Modules - Submarine  
Maintenance Enclosures with Retractable  
Roofs

**PROJECT HIGHLIGHTS:**

A very complex 80 foot long roof truss was  
fabricated in our Fabrication Shop.

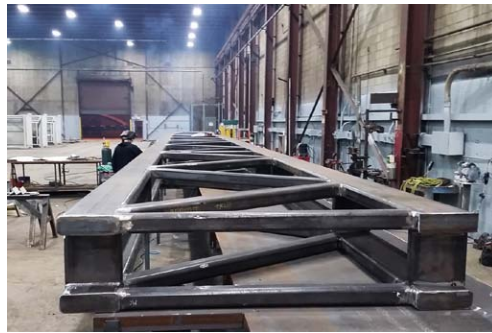

### ADDITIONAL DETAILS

The work included the fabrication of all structural steel and miscellaneous metals for new components, modification of existing components, all Navy-specified metal coatings, and erection/relocation of existing components for the Dry Dock#3 Propulsor Maintenance Enclosure at the Portsmouth Naval Shipyard in Kittery, ME. A key piece of this project was the fabrication, coating, and installation of motorized roofs for the maintenance enclosures. All components were fabricated at the Methuen Construction fabrication shop in Plaistow, NH and transported to the shipyard, which required multi-state permits and escorts.